

Architectural floor plan of a building. The plan shows a central staircase area with a red hatched pattern, surrounded by various rooms and corridors. Dimensions are provided for the overall building (13000 x 6200) and specific rooms (e.g., 7000 x 1000, 1080 x 1000). A note indicates a 'STEP HEIGHT OF 160MM'.

BACK CURTAIN

LX BAR 1 @ HEIGHT OF 3190MM

STEP HEIGHT OF 160MM

PLEASE NOTE

PLEASE NOTE

NO LIABILITY IS ACCEPTED FOR ANY ACTION RESULTING FROM THIS DRAWING, HOWEVER CAUSED. THIS DRAWING REPRESENTS VISUAL CONCEPTS AND CONSTRUCTION SUGGESTIONS ONLY. THE DRAUGHTSPERSON IS UNQUALIFIED TO DETERMINE STRUCTURAL APPROPRIATENESS OF THIS DESIGN AND WILL NOT BE RESPONSIBLE FOR IMPROPER ENGINEERING, CONSTRUCTION, RIGGING, HANDLING OR USE OF THIS SCENERY. IF PROFESSIONAL ADVICE/ DOCUMENTATION IS RECOMMENDED, IT MUST BE SOUGHT. ALL MATERIALS AND CONSTRUCTION MUST COMPLY WITH LOCAL FIRE AND SAFETY REGULATIONS. IF IN DOUBT... ASK!

ALL DIMENSIONS IN MM UNLESS STATED OTHERWISE. DO NOT SCALE FROM THIS DRAWING AND VERIFY ALL DIMENSIONS ON SITE.

ALL RIGHTS RESERVED. REPRODUCTION IN PART OR WHOLE, WITHOUT PERMISSION, IS PROHIBITED.

PROJECT:
#PROJECT

#PROJECT
SHEET TITLE:
NGS SWEENY YP.dwg
####

| | |
|-----------|-----------------|
| DIRECTOR: | #DIR MARC LEWIS |
| DESIGNER: | #DES |

LIGHTING DESIGNER:
#LX
SOUND DESIGNER:
#SD

| | |
|--|--------------------|
| | PRODUCTION MANAGER |
| | #PM |
| | 3D OFFICE CONTACT: |
| | #3DOFFICE |

VENUE:
#VENUE

PROVISIONAL

1/12/17 SCALE: Custom 1.25

PROPOSED /RAW## /9

FLOOR PLAN

- TO BE MADE AS SEPARATE 'DECKING' BECAUSE NOTHING CAN BE SCREWED INTO STAGE (WOODEN FLOOR).
- BECAUSE OF INSET STEEL DOOR FRAME NEEDS TO BE HIGHER THAN 40MM.
- IN MODEL @ 100MM BUT COULD BE LESS - TO BE DECIDED BETWEEN DESIGNER/MAKER
- TILES SAME AS WALLS - CNC SQUARE TILES
- PAINT FINISH - 'WHITE' AND FLINTS GLOSS
- TO BE USED AS PLATFORMS N FUTURE BY THE SCHOOL
- TO BE MADE OF MDF/PLY WHICH EVER WILL LAST LONGER/CHEAPER.

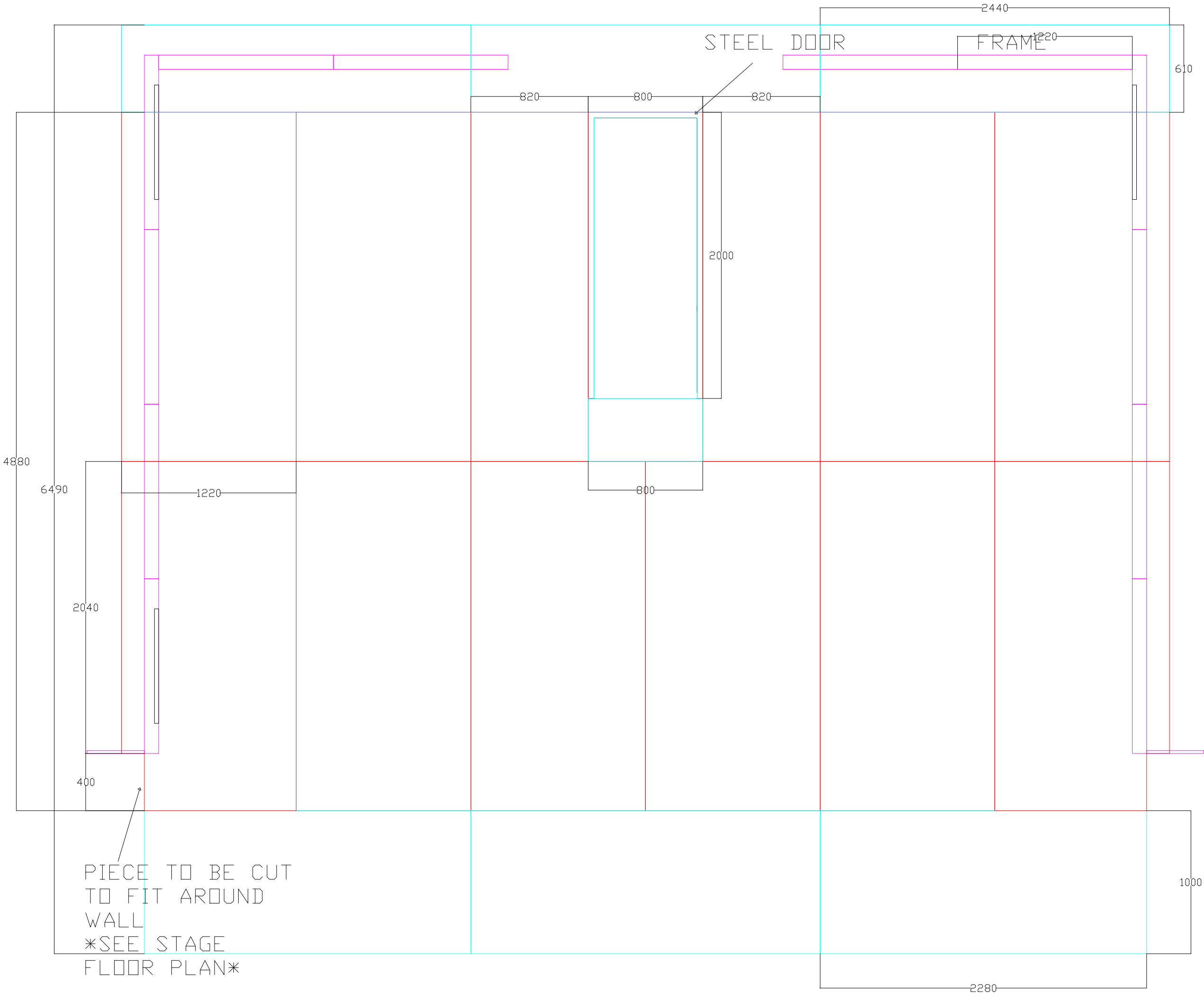

PLEASE NOTE
NO LIABILITY IS ACCEPTED FOR ANY ACTION RESULTING FROM THIS DRAWING, HOWEVER CAUSED. THIS DRAWING REPRESENTS VISUAL CONCEPTS AND CONSTRUCTION SUGGESTIONS ONLY. THE DRAUGHTSPERSON IS UNQUALIFIED TO DETERMINE STRUCTURAL APPROPRIATENESS OF THIS DESIGN AND WILL NOT BE RESPONSIBLE FOR IMPROPER ENGINEERING, CONSTRUCTION, RIGGING, HANDLING OR USE OF THIS SCENERY. IF PROFESSIONAL ADVICE/ DOCUMENTATION IS RECOMMENDED, IT MUST BE SOUGHT. ALL MATERIALS AND CONSTRUCTION MUST COMPLY WITH LOCAL FIRE AND SAFETY REGULATIONS. IF IN DOUBT... ASK!

ALL DIMENSIONS IN MM UNLESS STATED OTHERWISE. DO NOT SCALE FROM THIS DRAWING AND VERIFY ALL DIMENSIONS ON SITE.

ALL RIGHTS RESERVED. REPRODUCTION IN PART OR WHOLE, WITHOUT PERMISSION, IS PROHIBITED.

#DEPT

Tel: 020 7452 3333
Fax: 020 7452 3430
tuned@nationaltheatre.org.uk

PROJECT: #PROJECT
SHEET TITLE: NGS SWEENY YP.7.dwg
VENUE: #VENUE

DESIGNER: #DIR
LIGHTING DESIGNER: #LX
SOUND DESIGNER: #SND
PRODUCTION MANAGER: #PM
3D OFFICE CONTACT: #3DOFFICE X###
DRAWN BY: LUNED
APPROVED BY: NOT CHECKED

PROVISIONAL

DATE: ----
SCALE: Custom @A2L

REF. NUMBER: PROPO' ED /RAW## /9

WALLS

- THESE ARE MADE @2400X1220 - BECAUSE OF TILE SIZE@ 200X200
- NEED TO BE HOLLYWOOD FLATS AS DOOR IS IN CONSTANT USE BY ACTORS, NEEDS TO BE STRONG AND SOLID. *SEE PDF NO5*
- ALSO TO BE WEIGHTED WITH FRENCH BRACE OR SIMILAR FROM WALL TO FLOOR.

DOOR WAYS

- PIECES OF FURNITURE TO BE TAKEN THROUGH DOORS SO RAMPS FROM FLOOR TO DOORWAY @1220X1220 MAX.
- TO BE CUT AND KEPT AS DOOR *SEE MODEL/BELOW*

STAGE LEFT WALL - A

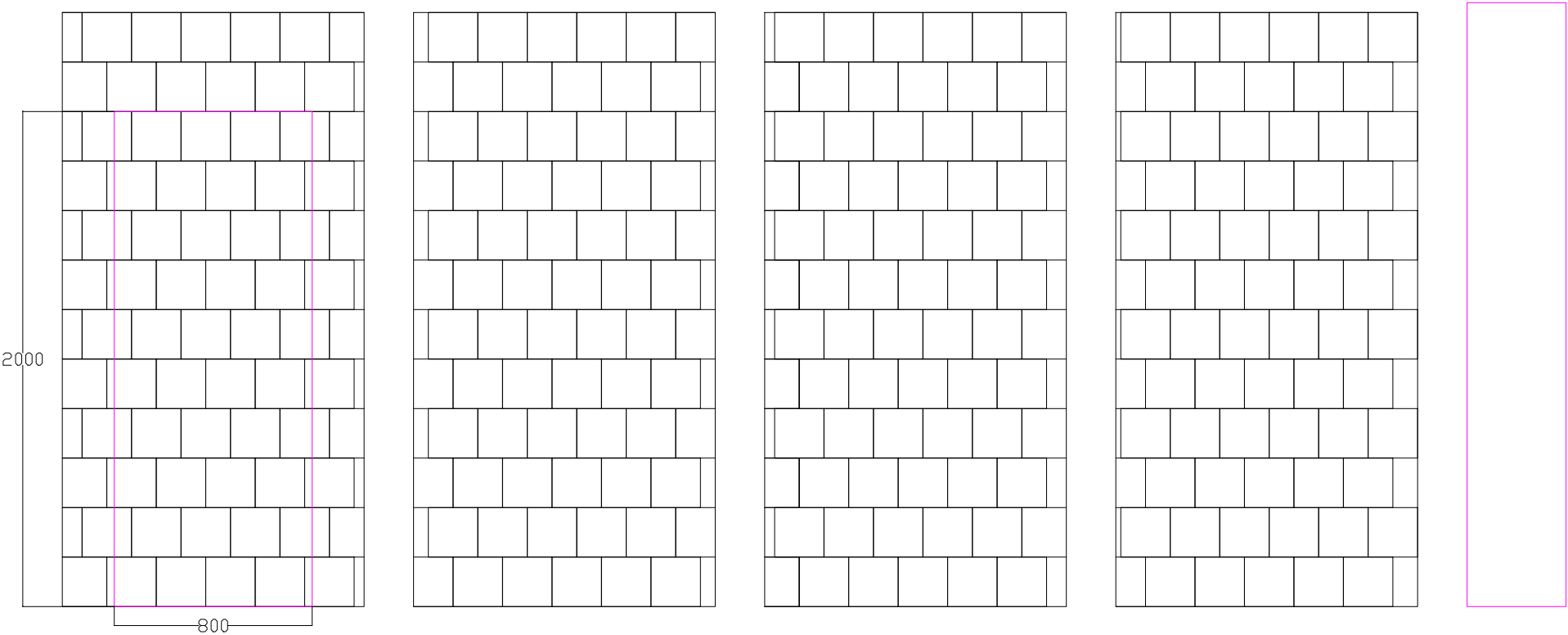

RETURN

BACK WALL - B

PLEASE NOTE

NO LIABILITY IS ACCEPTED FOR ANY ACTION RESULTING FROM THIS DRAWING, HOWEVER CAUSED. THIS DRAWING REPRESENTS VISUAL CONCEPTS AND CONSTRUCTION SUGGESTIONS ONLY. THE DRAUGHTSPERSON IS UNQUALIFIED TO DETERMINE STRUCTURAL APPROPRIATENESS OF THIS DESIGN AND WILL NOT BE RESPONSIBLE FOR IMPROPER ENGINEERING, CONSTRUCTION, RIGGING, HANDLING OR USE OF THIS SCENERY. IF PROFESSIONAL ADVICE/ DOCUMENTATION IS RECOMMENDED, IT MUST BE SOUGHT. ALL MATERIALS AND CONSTRUCTION MUST COMPLY WITH LOCAL FIRE AND SAFETY REGULATIONS. IF IN DOUBT... ASK!

ALL DIMENSIONS IN MM UNLESS STATED OTHERWISE. DO NOT SCALE FROM THIS DRAWING AND VERIFY ALL DIMENSIONS ON SITE.

ALL RIGHTS RESERVED. REPRODUCTION IN PART OR WHOLE, WITHOUT PERMISSION, IS PROHIBITED.

| | | | | | |
|--|-------------------------------------|---------------------------|---------------------------------------|------------------------------------|-----------------------|
| #DEPT | PROJECT: #PROJECT | VENUE: #VENUE | | PROVISIONAL | |
| | SHEET TITLE: NGS SWEENY YP.2.dwg | | | DATE: 21/12/17 | SCALE: Custom @A3L |
| #DIR | DIRECTOR: #DIR | LIGHTING DESIGNER: #LX | PRODUCTION MANAGER: #PM | DRAWN BY: LUNED | |
| | DESIGNER: #DES | SOUND DESIGNER: #SND | 3D OFFICE CONTACT: #3DOFFICE X#### | APPROVED BY: NOT CHECKED | |
| Tel: 020 7452 3333 Fax: 020 7452 3430 luned@nationaltheatre.org.uk | | | | REF. NUMBER: PROPOSED /RAW## /9 | |

BACK WALL - B

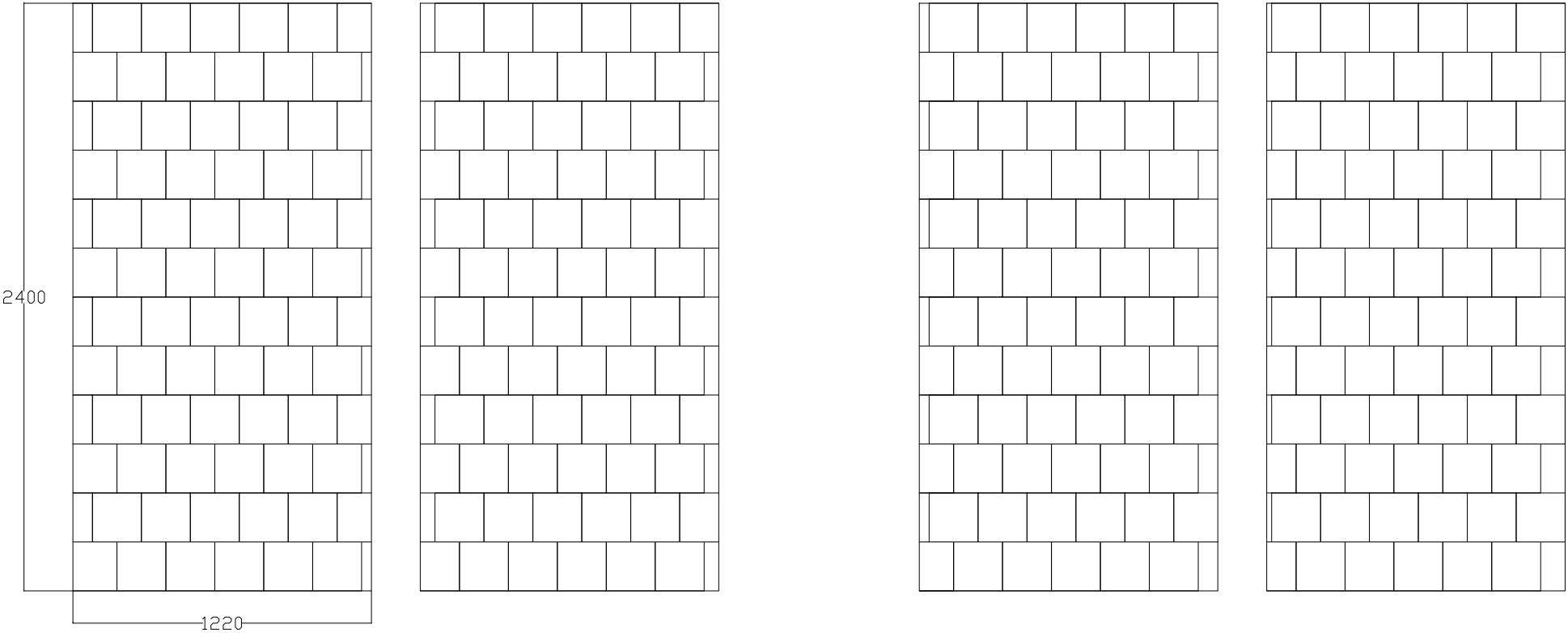

STAGE RIGHT WALL - C

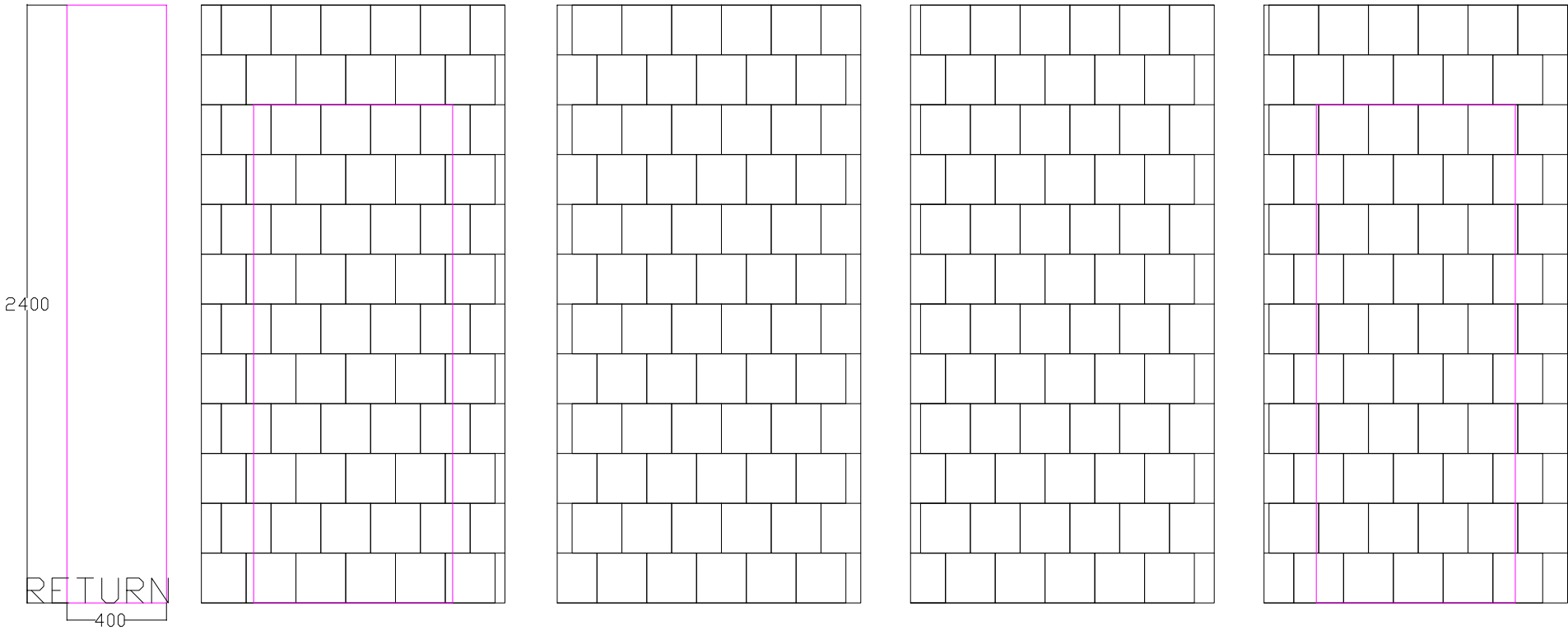

PLEASE NOTE

NO LIABILITY IS ACCEPTED FOR ANY ACTION RESULTING FROM THIS DRAWING, HOWEVER CAUSED. THIS DRAWING REPRESENTS VISUAL CONCEPTS AND CONSTRUCTION SUGGESTIONS ONLY. THE DRAUGHTSPERSON IS UNQUALIFIED TO DETERMINE STRUCTURAL APPROPRIATENESS OF THIS DESIGN AND WILL NOT BE RESPONSIBLE FOR IMPROPER ENGINEERING, CONSTRUCTION, RIGGING, HANDLING OR USE OF THIS SCENERY. IF PROFESSIONAL ADVICE/ DOCUMENTATION IS RECOMMENDED, IT MUST BE SOUGHT. ALL MATERIALS AND CONSTRUCTION MUST COMPLY WITH LOCAL FIRE AND SAFETY REGULATIONS. IF IN DOUBT... ASK!

ALL DIMENSIONS IN MM UNLESS STATED OTHERWISE. DO NOT SCALE FROM THIS DRAWING AND VERIFY ALL DIMENSIONS ON SITE.

ALL RIGHTS RESERVED. REPRODUCTION IN PART OR WHOLE, WITHOUT PERMISSION, IS PROHIBITED.

#DEPT

Tel: 020 7452 3333
Fax: 020 7452 3430
luned@nationaltheatre.org.uk

PROJECT:

#PROJECT

SHEET TITLE:

NGS SWEENY YP.2.dwg

####

DIRECTOR:

#DIR

DESIGNER:

#DES

LIGHTING DESIGNER:

#LX

SOUND DESIGNER:

#SND

PRODUCTION MANAGER:

#PM

3D OFFICE CONTACT:

#3DOFFICE X####

DRAWN BY:

LUNED

APPROVED BY:

NOT CHECKED

VENUE:

#VENUE

PROVISIONAL

DATE:

21/12/17

SCALE:

Custom

@A3L

REF. NUMBER:

PROPOSED /RAW## /9

EXAMPLE OF HOLLYWOOD FLAT WITH DOORWAY

- ALSO *SEE MODEL*
- DEPTH @100 - CAN BE NARROWER

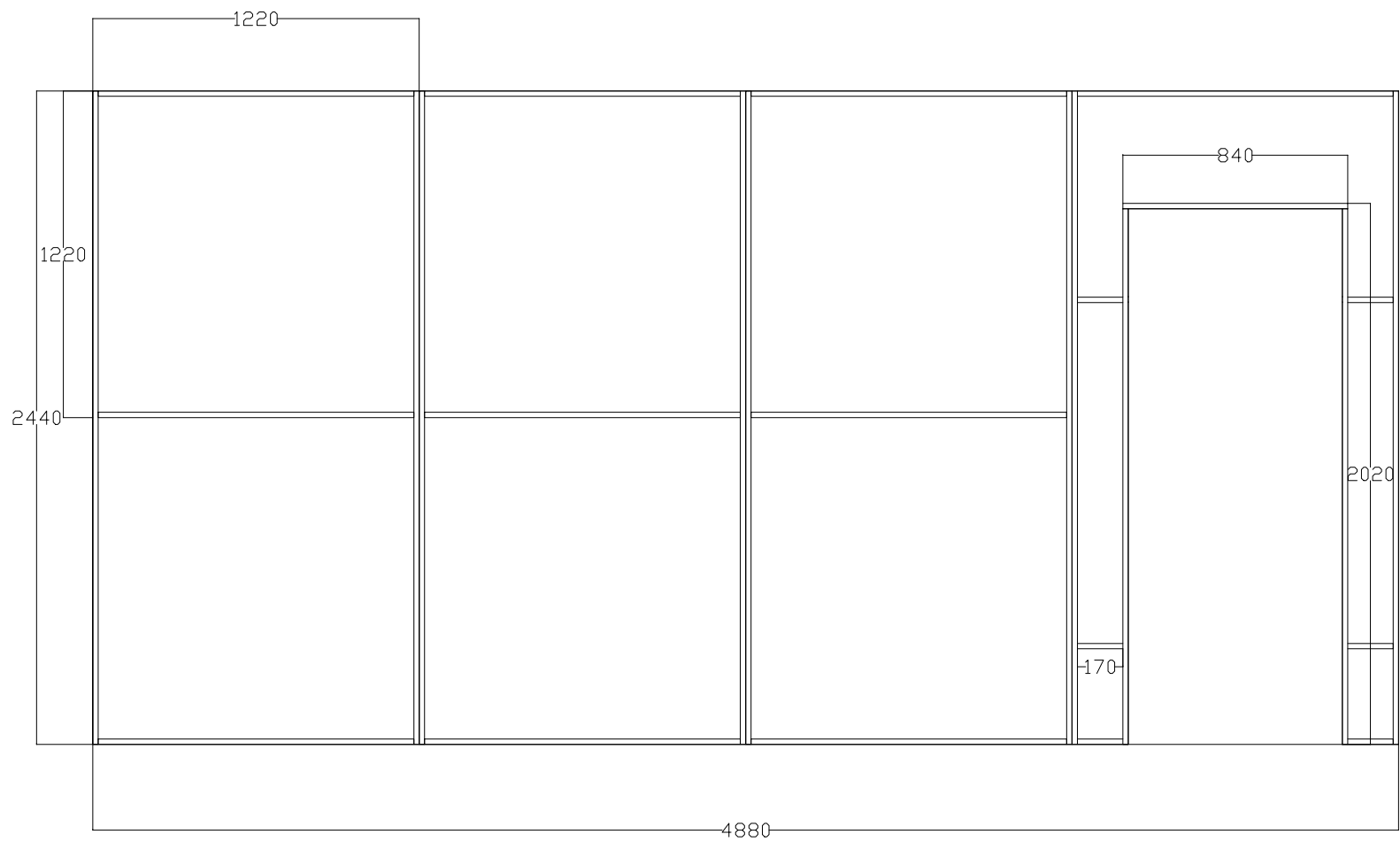

PLEASE NOTE

NO LIABILITY IS ACCEPTED FOR ANY ACTION RESULTING FROM THIS DRAWING, HOWEVER CAUSED. THIS DRAWING REPRESENTS VISUAL CONCEPTS AND CONSTRUCTION SUGGESTIONS ONLY. THE DRAUGHTSPERSON IS UNQUALIFIED TO DETERMINE STRUCTURAL APPROPRIATENESS OF THIS DESIGN AND WILL NOT BE RESPONSIBLE FOR IMPROPER ENGINEERING, CONSTRUCTION, RIGGING, HANDLING OR USE OF THIS SCENERY. IF PROFESSIONAL ADVICE/ DOCUMENTATION IS RECOMMENDED, IT MUST BE SOUGHT. ALL MATERIALS AND CONSTRUCTION MUST COMPLY WITH LOCAL FIRE AND SAFETY REGULATIONS. IF IN DOUBT... ASK!

ALL DIMENSIONS IN MM UNLESS STATED OTHERWISE. DO NOT SCALE FROM THIS DRAWING AND VERIFY ALL DIMENSIONS ON SITE.

ALL RIGHTS RESERVED. REPRODUCTION IN PART OR WHOLE, WITHOUT PERMISSION, IS PROHIBITED.

#DEPT

Tel: 020 7452 3333
Fax: 020 7452 3430
luned@nationaltheatre.org.uk

| | | | |
|-------------------------------------|---------------------------|---------------------------------------|-----------------------------|
| PROJECT: #PROJECT | | VENUE: #VENUE | |
| SHEET TITLE: NGS SWEENY YP.2.dwg | | | |
| ##### | | | |
| DIRECTOR: #DIR | LIGHTING DESIGNER: #LX | PRODUCTION MANAGER: #PM | DRAWN BY: LUNED |
| DESIGNER: #DES | SOUND DESIGNER: #SND | 3D OFFICE CONTACT: #3DOFFICE X#### | APPROVED BY: NOT CHECKED |

PROVISIONAL

DATE: 21/12/17
SCALE: Custom @A3L

REF. NUMBER: PROPOSED /RAW### /9

BRACES

TWO VARIOUS BRACES. NEEDS TO TAKE UP LITTLE ROOM AS POSSIBLE

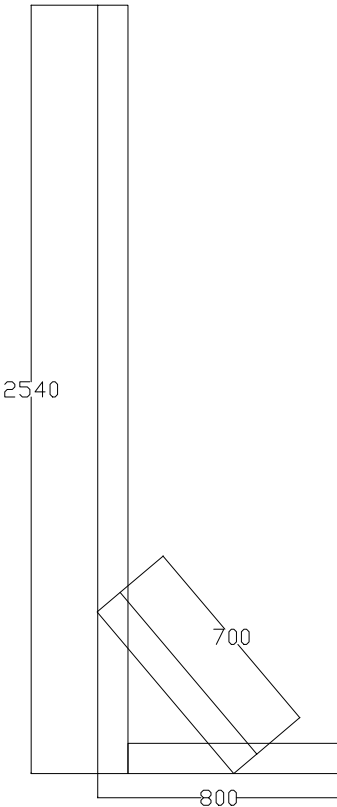

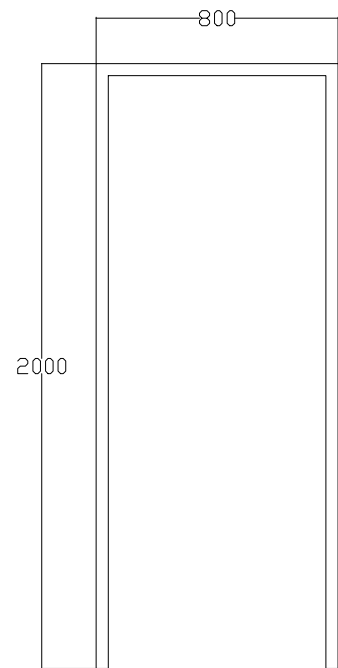

STEEL DOOR FRAME

- TO BE MADE OF BOX STEEL @40MM
- TO BE ON HINGES FROM PLATFORM PIECE TO DOOR FRAME
- IT CAN THEN BE LIFTED FROM FLOOR TO 90 DEGREE ANGLE TO CREATE DOORWAY.
- CAN BE PIN HINGED AT ONE SIDE TO STAY STABLE

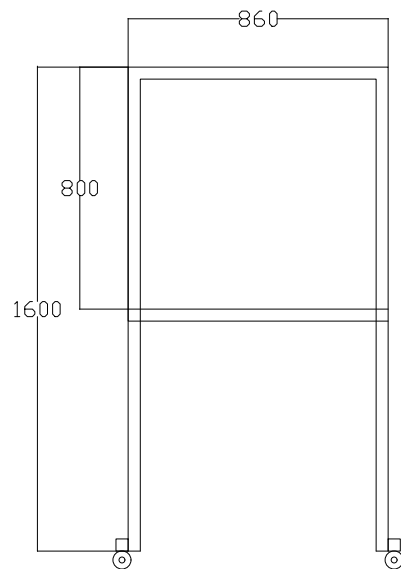

STEEL WINDOW FRAME

- TO BE MADE OF BOX STEEL @40MM
- ON CASTORS SO THAT IT CAN BE WHEELED ONTO STAGE AT VARIOUS POINTS.

PLEASE NOTE

NO LIABILITY IS ACCEPTED FOR ANY ACTION RESULTING FROM THIS DRAWING, HOWEVER CAUSED. THIS DRAWING REPRESENTS VISUAL CONCEPTS AND CONSTRUCTION SUGGESTIONS ONLY. THE DRAUGHTSPERSON IS UNQUALIFIED TO DETERMINE STRUCTURAL APPROPRIATENESS OF THIS DESIGN AND WILL NOT BE RESPONSIBLE FOR IMPROPER ENGINEERING, CONSTRUCTION, RIGGING, HANDLING OR USE OF THIS SCENERY. IF PROFESSIONAL ADVICE/ DOCUMENTATION IS RECOMMENDED, IT MUST BE SOUGHT. ALL MATERIALS AND CONSTRUCTION MUST COMPLY WITH LOCAL FIRE AND SAFETY REGULATIONS. IF IN DOUBT... ASK!

ALL DIMENSIONS IN MM UNLESS STATED OTHERWISE. DO NOT SCALE FROM THIS DRAWING AND VERIFY ALL DIMENSIONS ON SITE.

ALL RIGHTS RESERVED. REPRODUCTION IN PART OR WHOLE, WITHOUT PERMISSION, IS PROHIBITED.

| | | | | | | | |
|--|--|--|---------------------------|---------------------------------------|-----------------------------|--------------------|-----------------------|
| #DEPT | | PROJECT: #PROJECT | | VENUE: #VENUE | | PROVISIONAL | |
| | | SHEET TITLE: NGS SWEENY YP.7.dwg ##### | | | | DATE: ---- | SCALE: Custom @A3L |
| Tel: 020 7452 3333 Fax: 020 7452 3430 luned@nationaltheatre.org.uk | | DIRECTOR: #DIR | LIGHTING DESIGNER: #LX | PRODUCTION MANAGER: #PM | DRAWN BY: LUNED | REF. NUMBER: | |
| | | DESIGNER: #DES | SOUND DESIGNER: #SND | 3D OFFICE CONTACT: #3DOFFICE X#### | APPROVED BY: NOT CHECKED | PROPOSED /RAW## /9 | |

